

# Toma de Fuerza Power Take Off's

código code

1024450

8S-151, 16S-1621 TD/1921 TD/2221 TD/ 2321 TD/2331 TD  
16S-1821 TO/2221 TO/2521 TO/2721 TO/2731 TO, 16S-151/181/221.10  
10 Bolts. / Pistón Lateral / Side Piston  
2 Salidas Independientes / 2 Independent Outputs

# ZF

Posterior Neumático  
Rear Pneumatic



## Descripción Description

Toma de fuerza doble salida independiente de 3 piñones en toma constante, (salida superior 1:1,30) (salida inferior 1:1,72). Accionamiento neumático, montaje sobre el registro frontal de la caja de cambios. Indicadores de funcionamiento opcionales.

Twin output PTO for Pump and independent, (Upper Output 1:1,30) (Bottom Output 1:1,72) constant mesh. Pneumatic shifting, mounting rear 9 bolts-window of the Gearbox. Optional: Passing contact switches.

### Datos Principales (Salida Superior) Main Data ( Upper Output)

Par nominal Torque (Nm)	Continuo Continuous	350
	Intermitente Intermittent	490
Potencia (Cv) a 1000 r.p.m. Power (HP) 1000 r.p.m		52 C.V // 39 Kw
Sentido de giro Sense of rotation	Bomba Pump	Derecho Right Hand
	Plato Flange	Izquierdo Anti-Clock
Relación motor - Toma de Fuerza Engine to PTO ratio		ANEXO I ATTACHED I

### Datos Principales (Salida Inferior) Main Data ( Bottom Output)

Par nominal Torque (Nm)	Continuo Continuous	300
	Intermitente Intermittent	420
Potencia (Cv) a 1000 r.p.m. Power (HP) 1000 r.p.m		42 C.V // 32 Kw
Sentido de giro Sense of rotation	Bomba Pump	Derecho Right Hand
	Plato Flange	Izquierdo Anti-Clock
Relación motor - Toma de Fuerza Engine to PTO ratio		ANEXO II ATTACHED II

### Códigos y Combinaciones Codes and Combinations

Tipos de salidas Output types	Salida superior Upper Output	Plato Flange	Plato Flange	Bomba Pump	Bomba Pump
	Salida inferior Bottom Output	Plato Flange	Bomba Pump	Plato Flange	Bomba Pump
Accionamiento neumático Pneumatic shifting		1024452	1024451	1024450	1024453

# Toma de Fuerza Power Take Off's

código code

1024450

85-151, 16S-1621 TD/1921 TD/2221 TD/ 2321 TD/2331 TD  
 16S-1821 TO/2221 TO/2521 TO/2721 TO/2731 TO, 16S-151/181/221.10  
 10 Bolts. / Pistón Lateral / Side Piston  
 2 Salidas Independientes / 2 Independent Outputs

# ZF

Posterior Neumático

Rear Pneumatic

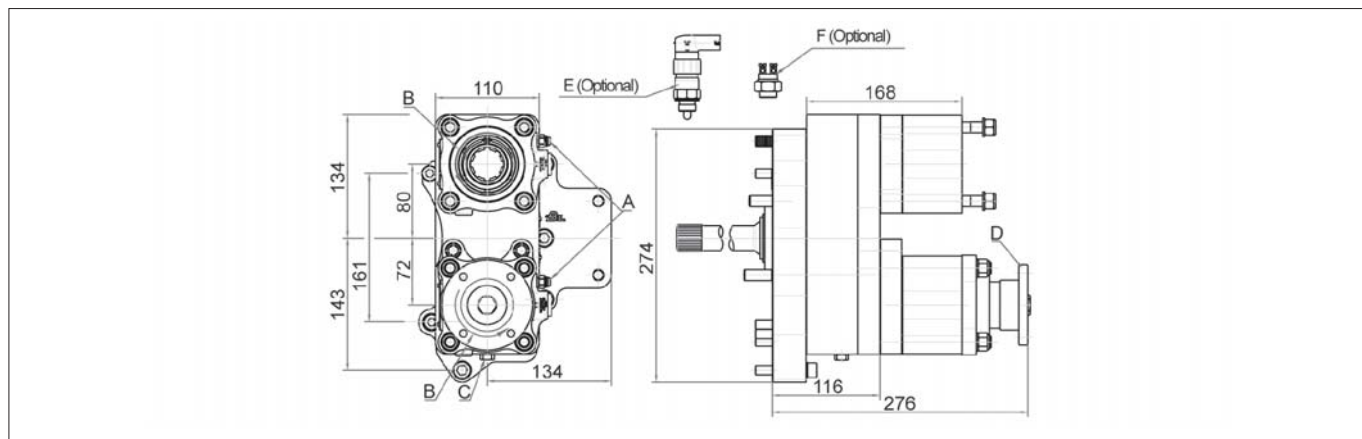

## Notas Notes

A	Tomas de aire, rosca 1/8" GAS.	A	Air connection, thread BSP 1/8"
B	Sentidos de giro	B	Senses of rotation
C	Tapón de drenaje del aceite	C	Oil drain plug
D	Brida de transmisión	D	Flange drive
E	Interruptores de contacto (9024999)	E	Passing contact switches. P/N 9024999
F	Interruptor neumático (100070018)	F	Pressure switch P/N (100070018)

## Datos Generales General Data

Peso Weight (Kg)	15
Lado de montaje Mounting side	Posterior Rear
Par máx. continuo en ambas salidas conjuntas Max. Continuous Torque for both outputs	490 Nm

## Tipos de Salida Output Types

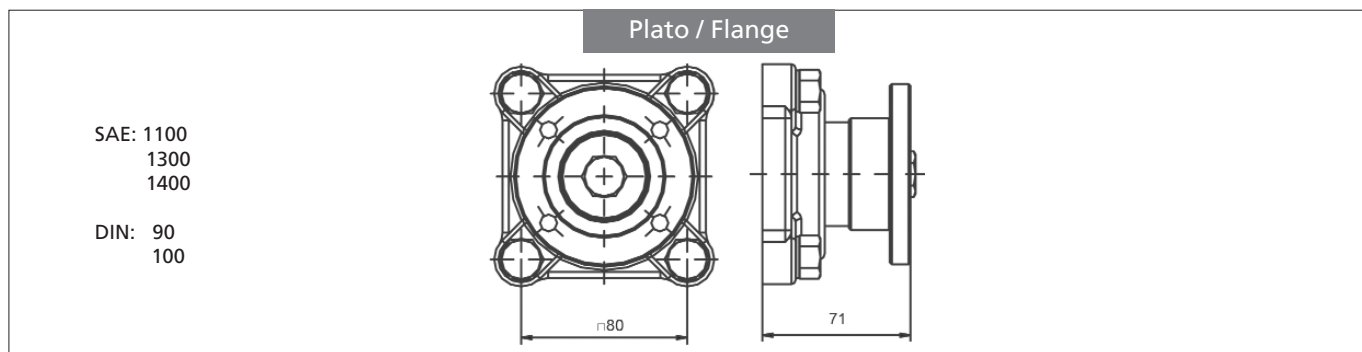

**BZ**  
bezares s.a.

Av. de las Retamas. Parcela:145. 45950. Casarrubios del Monte. Toledo (Spain) Tlf: +34 902 333 331  
 www.bezares.com bezares@bezares.com

# 24.15

# Toma de Fuerza Power Take Off's

código code

1024450

8S-151, 16S-1621 TD/1921 TD/2221 TD/ 2321 TD/2331 TD  
16S-1821 TO/2221 TO/2521 TO/2721 TO/2731 TO, 16S-151/181/221.10  
10 Bolts. / Pistón Lateral / Side Piston  
2 Salidas Independientes / 2 Independent Outputs

# ZF

Posterior Neumático

Rear Pneumatic

Anexo I Attached I

	CAJA GEARBOX	RELACIÓN RATIO	
8S	151/13.79	1: 1,234	
	1620 TD/13.80-1.0	1: 1,221	
	1820 TO/11.54-0.84	1: 1,462	
16S	151/13.85-0.84	Normal Normal	1: 1,033
		Larga High	1: 1,234
	1820 TO/13.80-0.84	Normal Normal	1: 1,221
		Larga High	1: 1,462
	2220 TO/13.80-0.84	Normal Normal	1: 1,221
		Larga High	1: 1,462
	2520 TO/13.80-0.84	Normal Normal	1: 1,221
		Larga High	1: 1,462
	2720 TO/13.80-0.84	Normal Normal	1: 1,221
		Larga High	1: 1,462
	2730 TO/13.80-0.84	Normal Normal	1: 1,221
		Larga High	1: 1,462
	1620 TD/16.41-1.0	Normal Normal	1: 1,033
		Larga High	1: 1,221
	1920 TD/16.41-1.0	Normal Normal	1: 1,033
		Larga High	1: 1,221
	2220 TD/16.41-1.0	Normal Normal	1: 1,033
		Larga High	1: 1,221
	2320 TD/16.41-1.0	Normal Normal	1: 1,033
		Larga High	1: 1,221
	2330 TD/16.41-1.0	Normal Normal	1: 1,033
		Larga High	1: 1,221
	151/13.80IT	Larga High	1: 1,196
		Normal Normal	1: 1,001
	151/13.85IT	Larga High	1: 1,196
		Normal Normal	1: 1,001
	151/16.41IT	Larga High	1: 1,196
		Normal Normal	1: 1,001
	151/16.47IT	Larga High	1: 1,196
		Normal Normal	1: 1,001
151/16.53IT	Larga High	1: 1,196	
	Normal Normal	1: 1,001	
181/13.80IT	Larga High	1: 1,196	
	Normal Normal	1: 1,001	
181/13.85IT	Larga High	1: 1,196	
	Normal Normal	1: 1,001	

	CAJA GEARBOX	RELACIÓN RATIO	
16S	181/16.41IT	Larga High	1: 1,196
		Normal Normal	1: 1,001
	181/16.47IT	Larga High	1: 1,196
		Normal Normal	1: 1,001
	181/16.53IT	Larga High	1: 1,196
		Normal Normal	1: 1,001
	221/13.80IT	Larga High	1: 1,196
		Normal Normal	1: 1,001
	221/13.85IT	Larga High	1: 1,196
		Normal Normal	1: 1,001
	221/16.41IT	Larga High	1: 1,196
		Normal Normal	1: 1,001
	221/16.47IT	Larga High	1: 1,196
		Normal Normal	1: 1,001
	221/16.53IT	Larga High	1: 1,196
		Normal Normal	1: 1,001
	1621 TD/16.41-1.0 IT	Larga High	1: 1,183
		Normal Normal	1: 1,001
	2221 TD/16.41-1.0 IT	Larga High	1: 1,183
		Normal Normal	1: 1,001
	2321 TD/16.41-1.0 IT	Larga High	1: 1,183
		Normal Normal	1: 1,001
	2331 TD/16.41-1.0 IT	Larga High	1: 1,183
		Normal Normal	1: 1,001
	1821 TO/13.80-0.84 IT	Larga High	1: 1,183
		Normal Normal	1: 1,001
	2221 TO/13.80-0.84 IT	Larga High	1: 1,417
		Normal Normal	1: 1,183
	2521 TO/13.80-0.84 IT	Larga High	1: 1,417
		Normal Normal	1: 1,183
2721 TO/13.80-0.84 IT	Larga High	1: 1,417	
	Normal Normal	1: 1,183	
2731 TO/13.80-0.84 IT	Larga High	1: 1,417	
	Normal Normal	1: 1,183	

# Toma de Fuerza Power Take Off's

código code

1024450

8S-151, 16S-1621 TD/1921 TD/2221 TD/ 2321 TD/2331 TD  
16S-1821 TO/2221 TO/2521 TO/2721 TO/2731 TO, 16S-151/181/221.10  
10 Bolts. / Pistón Lateral / Side Piston  
2 Salidas Independientes / 2 Independent Outputs

# ZF

Posterior Neumático

Rear Pneumatic

Anexo II Attached II

	CAJA GEARBOX	RELACIÓN RATIO
8S	151/13.79	1: 1,633
	1620 TD/13.80-1.0	1: 1,615
	1820 TO/11.54-0.84	1: 1,934
16S	151/13.85-0.84	Normal Normal 1: 1,366
		Larga High 1: 1,633
	1820 TO/13.80-0.84	Normal Normal 1: 1,615
		Larga High 1: 1,934
	2220 TO/13.80-0.84	Normal Normal 1: 1,615
		Larga High 1: 1,934
	2520 TO/13.80-0.84	Normal Normal 1: 1,615
		Larga High 1: 1,934
	2720 TO/13.80-0.84	Normal Normal 1: 1,615
		Larga High 1: 1,934
	2730 TO/13.80-0.84	Normal Normal 1: 1,615
		Larga High 1: 1,934
	1620 TD/16.41-1.0	Normal Normal 1: 1,366
		Larga High 1: 1,615
	1920 TD/16.41-1.0	Normal Normal 1: 1,366
		Larga High 1: 1,615
	2220 TD/16.41-1.0	Normal Normal 1: 1,366
		Larga High 1: 1,615
	2320 TD/16.41-1.0	Normal Normal 1: 1,366
		Larga High 1: 1,615
	2330 TD/16.41-1.0	Normal Normal 1: 1,366
		Larga High 1: 1,615
	151/13.80IT	Larga High 1: 1,582
		Normal Normal 1: 1,324
	151/13.85IT	Larga High 1: 1,582
		Normal Normal 1: 1,324
	151/16.41IT	Larga High 1: 1,582
Normal Normal 1: 1,324		
151/16.47IT	Larga High 1: 1,582	
	Normal Normal 1: 1,324	
151/16.53IT	Larga High 1: 1,582	
	Normal Normal 1: 1,324	
181/13.80IT	Larga High 1: 1,582	
	Normal Normal 1: 1,324	
181/13.85IT	Larga High 1: 1,582	
	Normal Normal 1: 1,324	

	CAJA GEARBOX	RELACIÓN RATIO
16S	181/16.41IT	Larga High 1: 1,582
		Normal Normal 1: 1,324
	181/16.47IT	Larga High 1: 1,582
		Normal Normal 1: 1,324
	181/16.53IT	Larga High 1: 1,582
		Normal Normal 1: 1,324
	221/13.80IT	Larga High 1: 1,582
		Normal Normal 1: 1,324
	221/13.85IT	Larga High 1: 1,582
		Normal Normal 1: 1,324
	221/16.41IT	Larga High 1: 1,582
		Normal Normal 1: 1,324
	221/16.47IT	Larga High 1: 1,582
		Normal Normal 1: 1,324
	221/16.53IT	Larga High 1: 1,582
		Normal Normal 1: 1,324
	1621 TD/16.41-1.0 IT	Larga High 1: 1,566
		Normal Normal 1: 1,324
	2221 TD/16.41-1.0 IT	Larga High 1: 1,566
		Normal Normal 1: 1,324
	2321 TD/16.41-1.0 IT	Larga High 1: 1,566
		Normal Normal 1: 1,324
	2331 TD/16.41-1.0 IT	Larga High 1: 1,566
		Normal Normal 1: 1,324
	1821 TO/13.80-0.84 IT	Larga High 1: 1,566
		Normal Normal 1: 1,324
	2221 TO/13.80-0.84 IT	Larga High 1: 1,874
Normal Normal 1: 1,566		
2521 TO/13.80-0.84 IT	Larga High 1: 1,874	
	Normal Normal 1: 1,566	
2721 TO/13.80-0.84 IT	Larga High 1: 1,874	
	Normal Normal 1: 1,566	
2731 TO/13.80-0.84 IT	Larga High 1: 1,874	
	Normal Normal 1: 1,566	