

Toma de Fuerza Power Take Off's

código code

1024550

S5-50, S5-90, S6-65, S6-66, S6-70S6-75, S6-80, S6-90
6S-800TO (Volvo ZTO 1006), 6S-1000TO, 6S-1200TD/TO
2 Salidas Independientes / 2 Independent output

ZF

Posterior Neumático

Rear Pneumatic



Descripción Description

Toma de fuerza doble salida 3 piñones, con latiguillo, relación en salida superior 1:1,30. Relación en salida de inferior 1:1,72. Montaje en el registro frontal de 4 taladros de la caja de cambios.

Power Take-off twin output 3 gears, with lubrication hose, ratio (Upper output) 1:1,30. Ratio (Bottom output) 1:1,72. Mounting on rear 4 bolts-window of the Gearbox.

Datos Principales (Salida Superior) Main Data (Upper Output)

Par nominal Torque (Nm)	Continuo Continuous	350
	Intermitente Intermittent	490
Potencia (Cv) a 1000 r.p.m. Power (HP) 1000 r.p.m		52 C.V // 39 Kw
Sentido de giro Sense of rotation	Bomba Pump	Derecho Right Hand
	Plato Flange	Izquierdo Anti-clock
Relación motor - Toma de Fuerza Engine to PTO ratio		ANEXO I ATTACHED I

Datos Principales (Salida Inferior) Main Data (Bottom Output)

Par nominal Torque (Nm)	Continuo Continuous	300
	Intermitente Intermittent	420
Potencia (Cv) a 1000 r.p.m. Power (HP) 1000 r.p.m		42 C.V // 32 Kw
Sentido de giro Sense of rotation	Bomba Pump	Derecho Right Hand
	Plato Flange	Izquierdo Anti-clock
Relación motor - Toma de Fuerza Engine to PTO ratio		ANEXO II ATTACHED II

Códigos y Combinaciones Codes and Combinations

Tipos de salidas Output types	Salida Superior Upper Output	Plato Flange	Plato Flange	Bomba Pump	Bomba Pump (DIN 5462)
	Salida Inferior Bottom Output	Plato Flange	Bomba Pump	Plato Flange	Bomba Pump
Accionamiento neumático Pneumatic shifting		1024552	1024551	1024550	1024553

Toma de Fuerza Power Take Off's

código code

1024550

S5-50, S5-90, S6-65, S6-66, S6-70S6-75, S6-80, S6-90
6S-800TO (Volvo ZTO 1006), 6S-1000TO, 6S-1200TD/TO
2 Salidas Independientes / 2 Independent output

ZF

Posterior Neumático
Rear Pneumatic

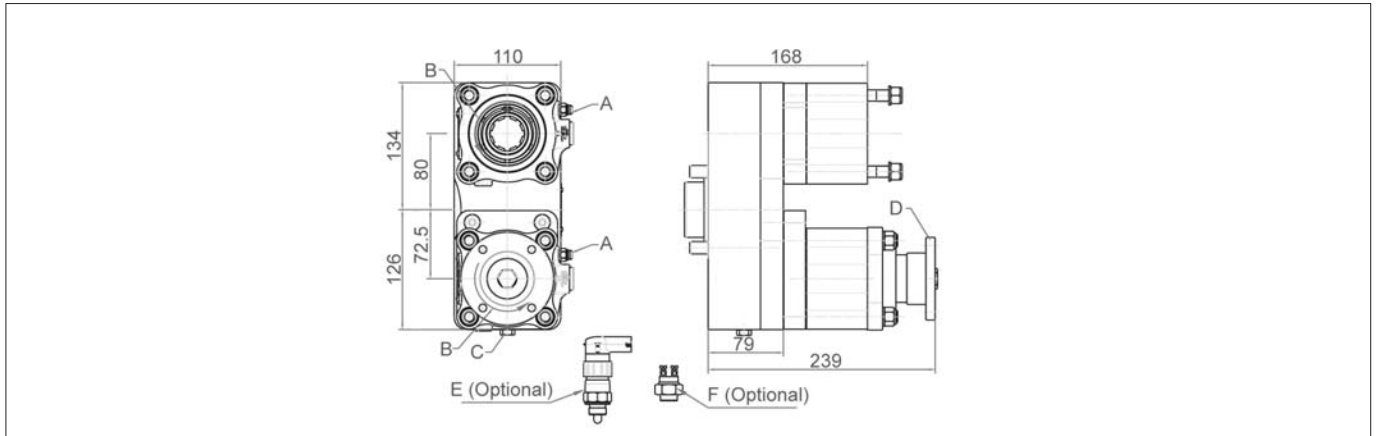

Notas Notes

Kit de lubricación. Código: 9015999		Lubrication kit. code: 9015999	
A	Tomas de aire, rosca 1/8" GAS.	A	Air connection, thread BSP 1/8"
B	Sentidos de giro	B	Senses of rotation
C	Tapón de drenaje del aceite	C	Oil drain plug
D	Brida de transmisión	D	Flange drive
E	Interruptor de contacto (9024999)	E	Passing contact switch. P/N 9024999
F	Interruptor neumático (100070018)	F	Pressure switch. P/N 100070018

Datos Generales General Data

Peso Weight (Kg)	15
Lado de montaje Mounting side	Posterior Rear
Par máx. continuo en ambas salidas conjuntas Max. Continuous Torque for both outputs	490 Nm

Tipos de Salida Output Types

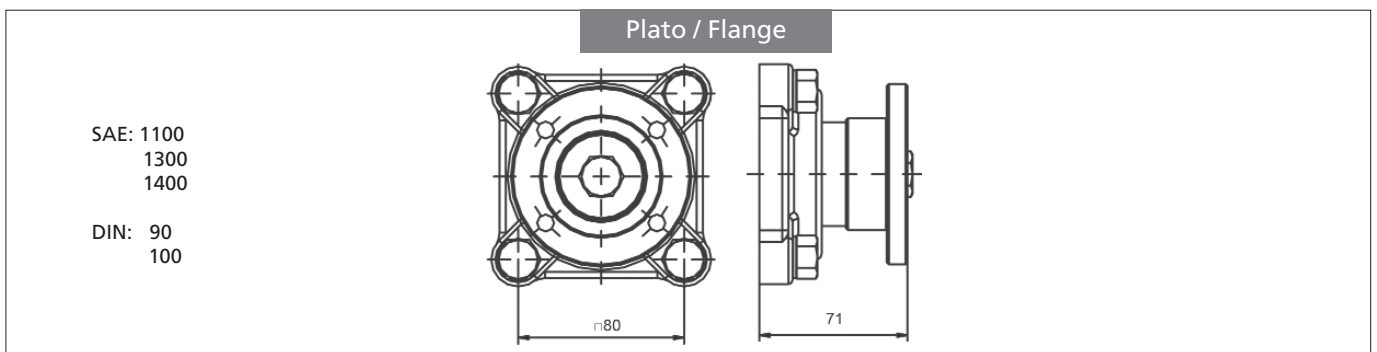

Toma de Fuerza Power Take Off's

código code

1024550

S5-50, S5-90, S6-65, S6-66, S6-70S6-75, S6-80, S6-90
6S-800TO (Volvo ZTO 1006), 6S-1000TO, 6S-1200TD/TO
2 Salidas Independientes / 2 Independent output

ZF

Posterior Neumático

Rear Pneumatic

Anexo I Attached I

	CAJA GEARBOX	RELACIÓN RATIO	
S5-50	/ 5.30	1: 0,847	
	/ 5.50	1: 0,798	
	/ 6.20	1: 0,707	
	/ 6.61	1: 0,663	
	/ 6.61+GV80	Larga High	1: 0,828
		Normal Normal	1: 0,663
	/ 8.02	1: 0,548	
	/ 8.02+GV80/6.20	Larga High	1: 0,707
Normal Normal		1: 0,548	
S5-90GP	/ GPA	1: 1,155	
S6-65	/ 6.37	1: 0,846	
	/ 6.70	1: 0,806	
	/ 7.0+GV70/7.67	Larga High	1: 0,592
		Normal Normal	1: 0,474
	/ 7.40	1: 0,729	
	/ 7.52	1: 0,720	
	/ 9.00	1: 0,600	
	/ 7.97+GV80/6.70	Larga High	1: 0,805
		Normal Normal	1: 0,682
	/ 9.00+GV80/6.70	Larga High	1: 0,805
		Normal Normal	1: 0,601
	/ 9.00+GV80/7.52	Larga High	1: 0,720
Normal Normal		1: 0,601	
S6-66	/ 7.36-1.0	1: 0,678	
	/ 9.06-1.0	1: 0,541	
S6-70	/ 6.8	1: 0,668	
	/ 6.8+GV70/5.71	Larga High	1: 0,795
		Normal Normal	1: 0,668
	/ 7.36	1: 0,619	
	/ 7.92	1: 0,572	
	/ 9.03	1: 0,502	
/ 9.59	1: 0,474		
S6-75	/ 6.70+GV80/7.52	Normal Normal	1: 0,805
		Corta Low	1: 0,720
S6-80	/ 5.03	1: 1,012	
	/ 5.66	1: 0,964	

	CAJA GEARBOX	RELACIÓN RATIO	
S6-80	/ 5.66+GV80/7.52	Larga High	1: 0,958
		Normal Normal	1: 0,721
	/ 6.10	1: 0,893	
	/ 6.7	1: 0,806	
	/ 6.7+GV80/5.30	Larga High	1: 1,022
		Normal Normal	1: 0,805
	/ 6.90	1: 0,668	
	/ 7.35	1: 0,716	
	/ 7.41	1: 0,731	
	/ 7.53	1: 0,720	
	/ 7.67	1: 0,698	
	/ 7.67+GV80/6.7	Larga High	1: 0,807
		Normal Normal	1: 0,704
	/ 7.90	1: 0,681	
	/ 9.00	1: 0,600	
	/ 9.00+GV80/5.30	Larga High	1: 1,022
Normal Normal		1: 0,601	
/ 9.00+GV80/7.48	Larga High	1: 0,731	
	Normal Normal	1: 0,601	
/ 9.00+GV80/7.52	Larga High	1: 0,720	
	Normal Normal	1: 0,601	
S6-90	/ 5.67	1: 0,974	
	/ 5.74	1: 0,964	
	/ 6.37	1: 0,964	
	/ 6.98	1: 0,794	
	/ 7.03	1: 0,783	
	/ 7.03+GV90/5.67	Larga High	1: 0,973
		Normal Normal	1: 0,783
	/ 7.03+GV90/5.74	Larga High	1: 0,954
		Normal Normal	1: 0,777
	/ 7.40	1: 0,746	
/ 9.01	1: 0,610		
S6-75	/ 6.70+GV80/7.52	Larga High	1: 0,744
		Normal Normal	1: 0,612
6S800TO/6.58-0.78(Volvo ZTO 1006)		1: 0,689	
6S1000TO/6.75 - 0.78		1: 0,689	
6S1200TD/7.72 - 1.00		1: 0,702	
6S1200TO/6.75 - 0.83		1: 0,806	

Toma de Fuerza Power Take Off's

código code

1024550

S5-50, S5-90, S6-65, S6-66, S6-70S6-75, S6-80, S6-90
6S-800TO (Volvo ZTO 1006), 6S-1000TO, 6S-1200TD/TO
2 Salidas Independientes / 2 Independent output

ZF

Posterior Neumático

Rear Pneumatic

Anexo II Attached II

CAJA GEARBOX		RELACIÓN RATIO		
S5-50	/ 5.30	1: 1,123		
	/ 5.50	1: 1,057		
	/ 6.20	1: 1,937		
	/ 6.61	1: 1,877		
	/ 6.61+GV80	Larga High	1: 1,095	
		Normal Normal	1: 0,877	
	/ 8.02	1: 0,725		
/ 8.02+GV80/6.20	Larga High	1: 0,937		
	Normal Normal	1: 0,723		
S5-90GP	/ GPA	1: 1,531		
S6-65	/ 6.37	1: 1,118		
	/ 6.70	1: 1,066		
	/ 7.0+GV70/7.67	Larga High	1: 0,784	
		Normal Normal	1: 0,627	
	/ 7.40	1: 0,966		
	/ 7.52	1: 0,954		
	/ 9.00	1: 0,794		
	/ 7.97+GV80/6.70	Larga High	1: 1,066	
		Normal Normal	1: 0,902	
	/ 9.00+GV80/6.70	Larga High	1: 1,066	
		Normal Normal	1: 0,794	
/ 9.00+GV80/7.52	Larga High	1: 0,952		
	Normal Normal	1: 0,794		
S6-66	/ 7.36-1.0	1: 0,897		
	/ 9.06-1.0	1: 0,715		
S6-70	/ 6.8	1: 0,883		
	/ 6.8+GV70/5.71	Larga High	1: 1,052	
		Normal Normal	1: 0,883	
	/ 7.36	1: 0,822		
	/ 7.92	1: 0,758		
	/ 9.03	1: 0,665		
/ 9.59	1: 0,627			
S6-75	/ 6.70+GV80/7.52	Normal Normal	1: 1,066	
		Corta Low	1: 0,952	
S6-80	/ 5.03	1: 1,342		
	/ 5.66	1: 1,273		

CAJA GEARBOX		RELACIÓN RATIO		
S6-80	/ 5.66+GV80/7.52	Larga High	1: 1,269	
		Normal Normal	1: 0,956	
	/ 6.10	1: 1,183		
	/ 6.7	1: 1,066		
	/ 6.7+GV80/5.30	Larga High	1: 1,353	
		Normal Normal	1: 1,066	
	/ 6.90	1: 0,885		
	/ 7.35	1: 0,949		
	/ 7.41	1: 0,968		
	/ 7.53	1: 0,954		
	/ 7.67	1: 0,929		
	/ 7.67+GV80/6.7	Larga High	1: 1,069	
		Normal Normal	1: 0,934	
	/ 7.90	1: 0,902		
	/ 9.00	1: 0,791		
	/ 9.00+GV80/5.30	Larga High	1: 1,353	
Normal Normal		1: 0,794		
/ 9.00+GV80/7.48	Larga High	1: 0,966		
	Normal Normal	1: 0,794		
/ 9.00+GV80/7.52	Larga High	1: 0,952		
	Normal Normal	1: 0,794		
S6-90	/ 5.67	1: 1,290		
	/ 5.74	1: 1,273		
	/ 6.37	1: 1,273		
	/ 6.98	1: 1,052		
	/ 7.03	1: 1,037		
	/ 7.03+GV90/5.67	Larga High	1: 1,290	
		Normal Normal	1: 1,037	
	/ 7.03+GV90/5.74	Larga High	1: 1,264	
		Normal Normal	1: 1,032	
	/ 7.40	1: 0,988		
/ 9.01	1: 0,808			
S6-75	/ 6.70+GV80/7.52	Larga High	1: 0,985	
		Normal Normal	1: 0,809	
6S800TO/6.58-0.78(Volvo ZTO 1006)		1: 0,912		
6S1000TO/6.75 - 0.78		1: 0,912		
6S1200TD/7.72 - 1.00		1: 0,929		
6S1200TO/6.75 - 0.83		1: 1,066		