

# Toma de Fuerza Power Take Off's

código code

1026003

S5-50, S5-90, S6-65, S6-66, S6-70S6-75, S6-80, S6-90,  
6S-800TO (Volvo ZTO 1006), 6S-1000TO, 6S-1200TD/TO

# ZF

Posterior Neumático (1: 1,5)  
Rear Pneumatic



## Descripción Description

Toma de fuerza de 2 piñones, para montar en el registro frontal de 4 taladros de la caja de cambios. Accionamiento neumático y salida girada para bombas ISO 4 taladros.

Power Take-off two gears, mounting on rear 4 bolts-windows of the Gearbox. Pneumatic shifting and ISO 4 bolts pump rotated output.

## Datos Principales Main Data

Par nominal Torque (Nm)	Continuo Continuous	300
	Intermitente Intermittent	420
Potencia (Cv) a 1000 r.p.m. Power (HP) 1000 r.p.m	42 C.V // 32 Kw	
Lado de montaje Mounting position	Posterior Rear	
Sentido de giro de la bomba Pump rotation	Derecho Right Hand	
Peso Weight (Kg)	11	
Relación motor - Toma de Fuerza Engine to PTO ratio	ANEXO ATTACHMENT	

## Códigos y Combinaciones Codes and Combinations

Tipos de salida Output types	Eje Shaft	Plato Flange	Bomba Pump (DIN 5462)
Accionamiento neumático Pneumatic shifting		1026002	1026003

# Toma de Fuerza Power Take Off's

código code

1026003

S5-50, S5-90, S6-65, S6-66, S6-70S6-75, S6-80, S6-90  
6S-800TO (Volvo ZTO 1006), 6S-1000TO, 6S-1200TD/TO

# ZF

Posterior Neumático (1: 1,5)

Rear Pneumatic

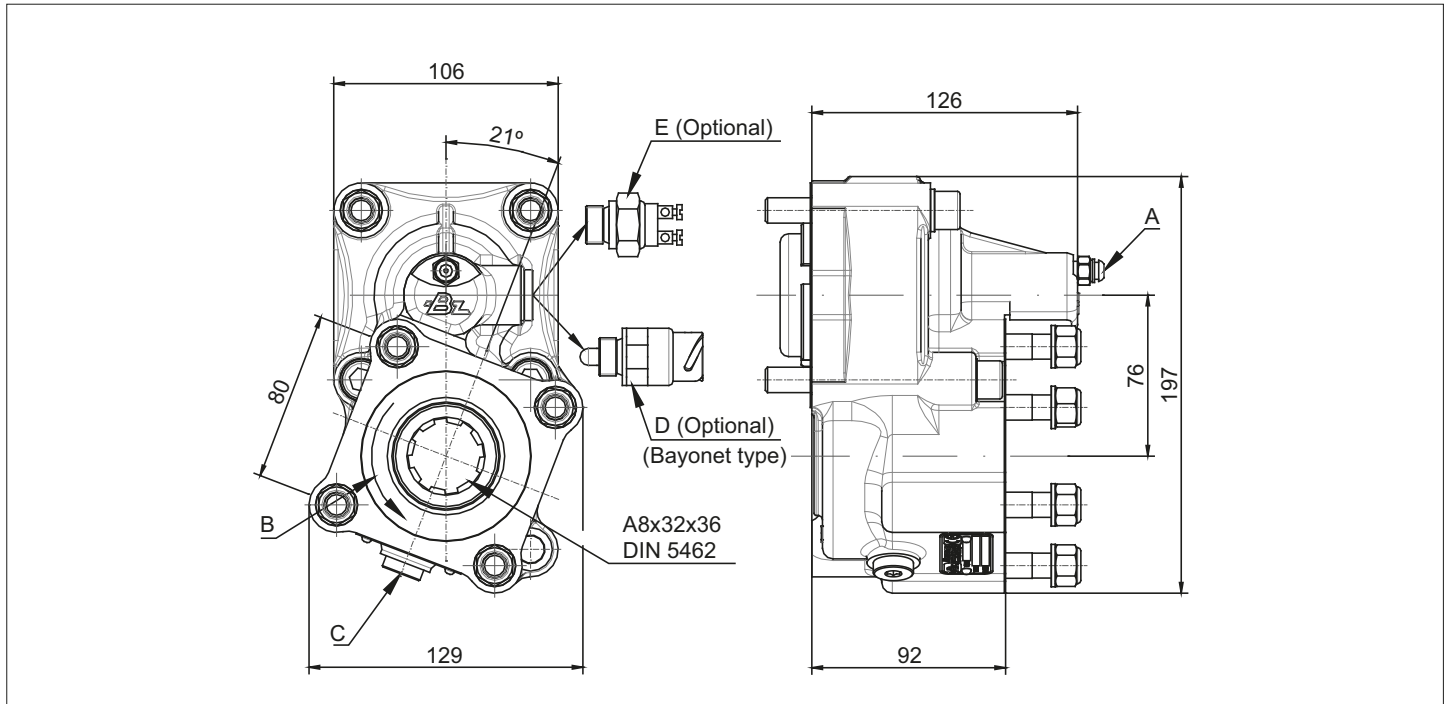

## Notas Notes

A	Toma de aire, rosca 1/8" GAS	A	Engage PTO, thread 1/8" BSP
B	Sentido de giro	B	Rotation
C	Tapón de drenaje del aceite	C	Oil drain plug
D	Interruptor de contacto opcional (9024999)	D	Passing contact switch (Optional) P/N 9024999
E	Interruptor neumático opcional (100070018)	E	Pressure switch. P/N. (Optional) 100070018

## Tipos de Salida Output Types

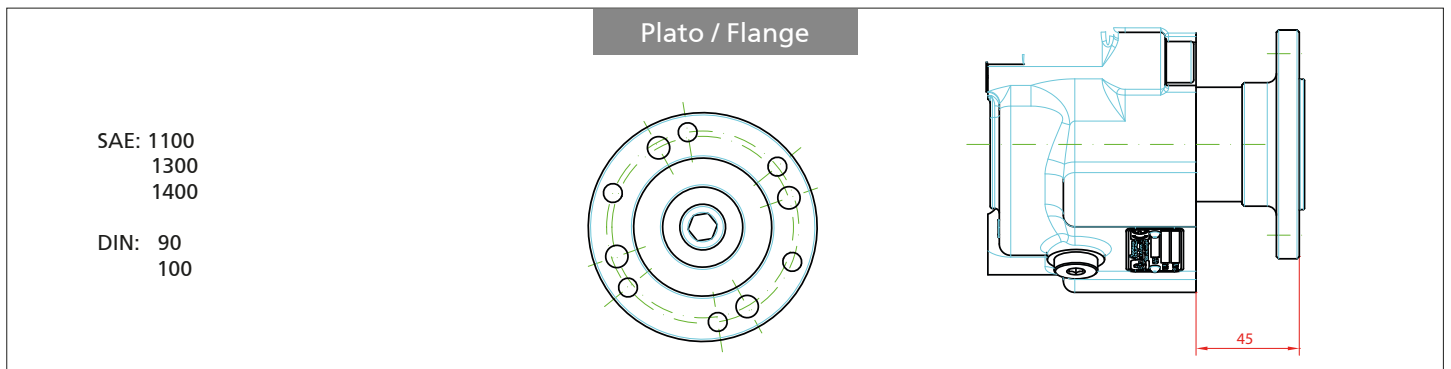

878

# Toma de Fuerza Power Take Off's

código code

1026003

S5-50, S5-90, S6-65, S6-66, S6-70S6-75, S6-80, S6-90  
6S-800TO (Volvo ZTO 1006), 6S-1000TO, 6S-1200TD/TO

# ZF

Posterior Neumático (1: 1,5)

Rear Pneumatic

CAJA GEARBOX		RELACIÓN RATIO	
S5-50	/ 5.30	1: 0,999	
	/ 5.50	1: 0,941	
	/ 6.20	1: 0,834	
	/ 6.61	1: 0,78	
	/ 6.61+GV80	Larga High	1: 0,975
		Normal Normal	1: 0,78
	/ 8.02	1: 0,646	
	/ 8.02+GV80/6.20	Larga High	1: 0,834
Normal Normal		1: 0,644	
S5-90GP	/ GPA	1: 1,362	
S6-65	/ 6.37	1: 0,995	
	/ 6.70	1: 0,949	
	/ 7.0+GV70/7.67	Larga High	1: 0,698
		Normal Normal	1: 0,558
	/ 7.40	1: 0,86	
	/ 7.52	1: 0,849	
	/ 9.00	1: 0,707	
	/ 7.97+GV80/6.70	Larga High	1: 0,949
		Normal Normal	1: 0,803
	/ 9.00+GV80/6.70	Larga High	1: 0,949
		Normal Normal	1: 0,707
	/ 9.00+GV80/7.52	Larga High	1: 0,848
Normal Normal		1: 0,707	
S6-66	/ 7.36-1.0	1: 0,799	
	/ 9.06-1.0	1: 0,636	
S6-70	/ 6.8	1: 0,786	
	/ 6.8+GV70/5.71	Larga High	1: 0,936
		Normal Normal	1: 0,786
	/ 7.36	1: 0,731	
	/ 7.92	1: 0,675	
	/ 9.03	1: 0,592	
/ 9.59	1: 0,558		
S6-75	/ 6.70+GV80/7.52	Normal Normal	1: 0,949
		Corta Low	1: 0,848
S6-80	/ 5.03	1: 1,193	
	/ 5.66	1: 1,132	

CAJA GEARBOX		RELACIÓN RATIO	
S6-80	/ 5.66+GV80/7.52	Larga High	1: 1,129
		Normal Normal	1: 0,851
	/ 6.10	1: 1,053	
	/ 6.7	1: 0,949	
	/ 6.7+GV80/5.30	Larga High	1: 1,204
		Normal Normal	1: 0,949
	/ 6.90	1: 0,788	
	/ 7.35	1: 0,845	
	/ 7.41	1: 0,861	
	/ 7.53	1: 0,849	
	/ 7.67	1: 0,826	
	/ 7.67+GV80/6.7	Larga High	1: 0,952
		Normal Normal	1: 0,831
	/ 7.90	1: 0,803	
	/ 9.00	1: 0,704	
	/ 9.00+GV80/5.30	Larga High	1: 1,204
		Normal Normal	1: 0,707
	/ 9.00+GV80/7.48	Larga High	1: 0,86
Normal Normal		1: 0,707	
/ 9.00+GV80/7.52	Larga High	1: 0,848	
	Normal Normal	1: 0,707	
S6-90	/5.67	1: 1,148	
	/5.74	1: 1,132	
	/6.37	1: 1,132	
	/6.98	1: 0,936	
	/7.03	1: 0,923	
	/ 7.03+GV90/5.67	Larga High	1: 1,148
		Normal Normal	1: 0,923
	/ 7.03+GV90/5.74	Larga High	1: 1,125
		Normal Normal	1: 0,918
	/7.40	1: 0,88	
	/ 9.01	1: 0,719	
	/ 9.01+GV90/7.40	Larga High	1: 0,877
Normal Normal		1: 0,721	
6S800TO/6.58-0.78(Volvo ZTO 1006)		1: 0,811	
6S1000TO/6.75 - 0.78		1: 0,811	
6S1200TD/7.72 - 1.00		1: 0,826	
6S1200TO/6.75 - 0.83		1: 0,949	